

BALL VALVE, THREE PIECE, THD

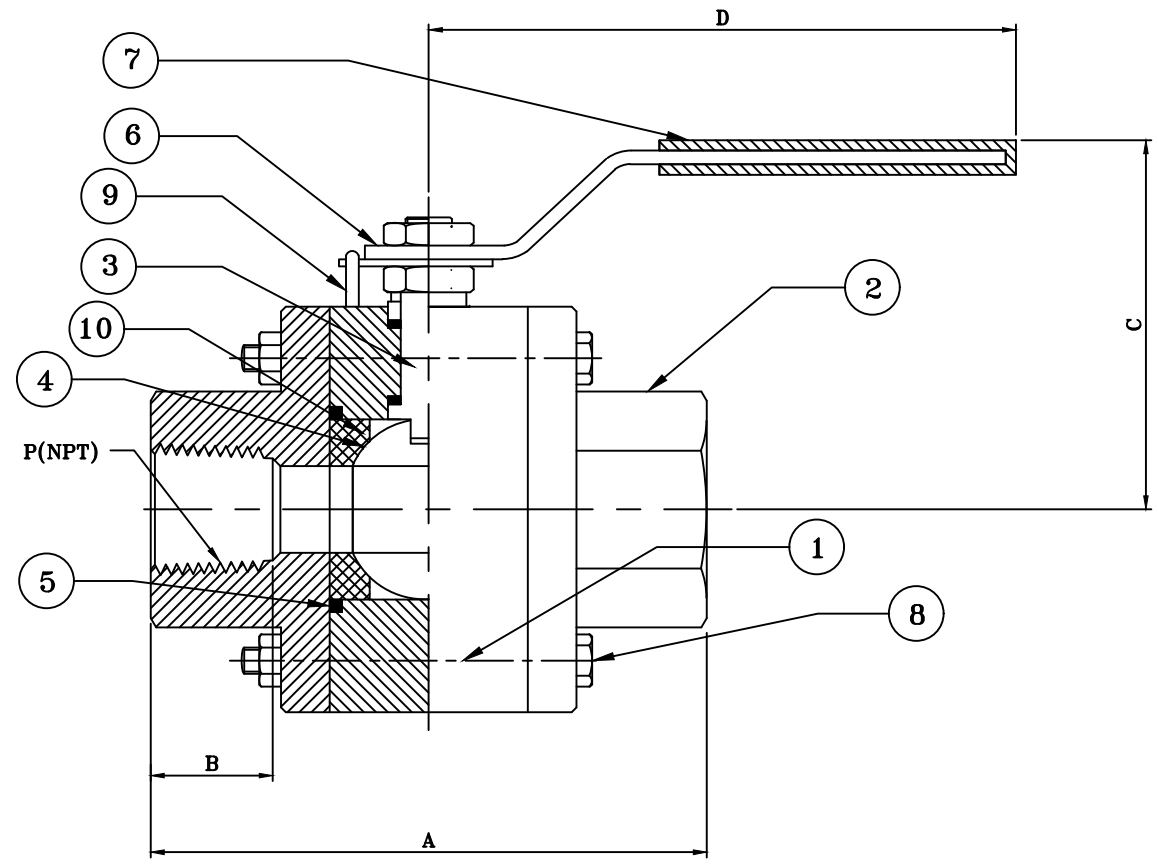

10.	SEAL	2	P.T.F.E/TEFLON
9.	STOPPER PIN	1	SS 304
8.	BOLTS WITH NUTS	4	SS 304
7.	SLEEVE	1	PVC
6.	HANDLE	1	C.S (POWDER COATED)
5.	PACKING RING	2	P.T.F.E/TEFLON
4.	BALL	1	SS 316
3.	SPINDLE	1	SS 316
2.	ADAPTOR	2	SS 316
1.	BODY	1	SS 316
SR.NO	DESCRIPTION	QTY	MATERIALS
BILL OF MATERIAL			

3 PIECE BALL VALVE (NPTF)						
PART NO	P(NPT)	SIZE	A	B	C	D
BV8N3P	1/2"	1/2"	66.0	13.6	19.0	57.0
BV12N3P	3/4"	3/4"	80.0	13.9	19.0	70.0
BV16N3P	1"	1"	101.0	17.3	24.0	95.0

NOTES:
 1) ALL DIMENSIONS ARE IN MM. UNLESS SPECIFIED.
 2) PARTS TO BE FREE FROM BURR.
 3) GENERAL TOLERANCE : ± 1MM.
 4) REF. STD. : API 598/608/ISO 17292/ASME B1.20.1/BS 5351.

TEST PRESSURE								DATE	BY	CUSTOMER : BHEL, HYDERABAD	
AIR TEST		7 Kg/Cm ²						DRAWN	01.04.10	AL	
HYDRO TEST		BODY	60 Kg/Cm ²					CHECKED			
		SEAT	40 Kg/Cm ²					APPROVAL			
				NO	DESCRIPTION	SIGN	DATE				
				REVISION				SCALE : NTS		MATERIAL : SS 316	

Swastik Engg. Works
 GOREGAON (EAST), MUMBAI-400 063.

REV.: 0