

BALL VALVE BSP(F).

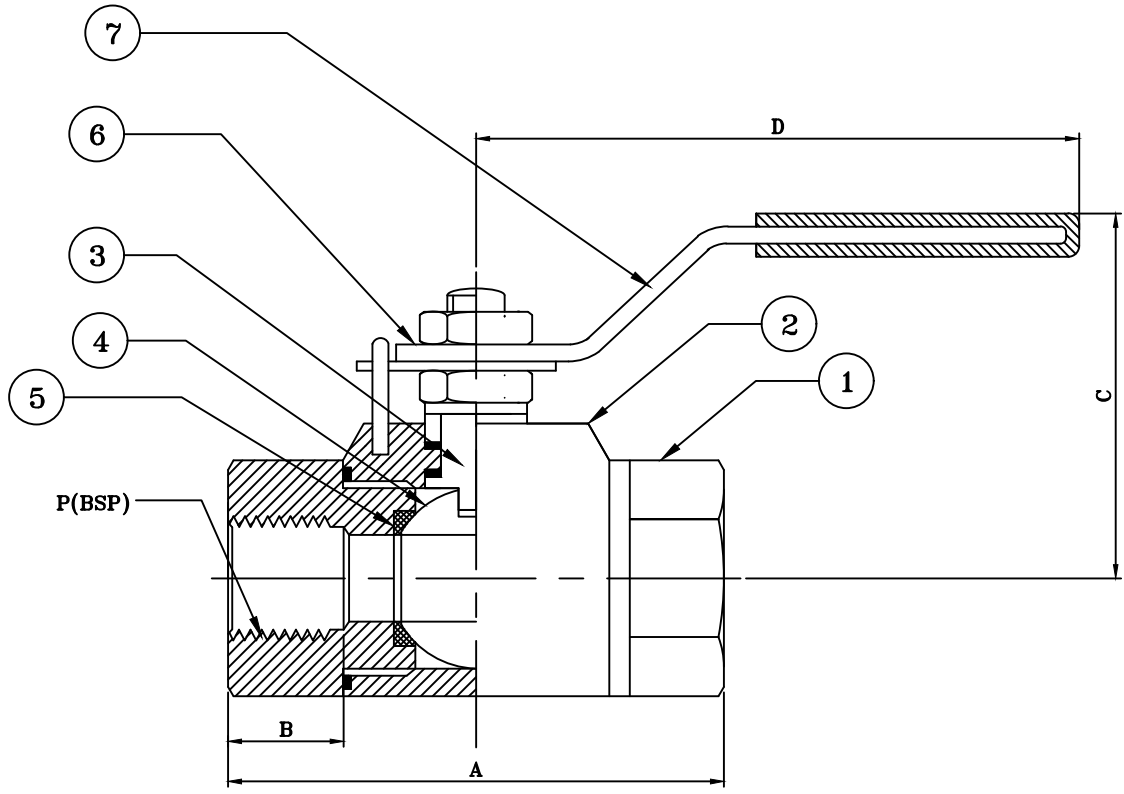

7.	SLEEVE	1	PVC
6.	HANDLE	1	C.S (POWDERED COATED)
5.	SEAT	2	P.T.F.E/TEFLON
4.	BALL	1	SA276 TP. 304/304L/316/316L
3.	SPINDLE	1	SA276 TP. 304/304L/316/316L
2.	ADAPTOR	1	SA182 Gr.F304/304L/316/316L
1.	BODY	1	SA182 Gr.F304/304L/316/316L
SR.NO	DESCRIPTION	QTY	MATERIALS
BILL OF MATERIAL			

BALL VALVE (NPTF)						
PART NO	P(BSP)	SIZE	A	B	C	D
BV4B	1/4"	1/4"	50.0	10.2	14.2	30.0
BV6B	3/8"	3/8"	60.0	10.4	14.2	45.0
BV8B	1/2"	1/2"	70.0	13.6	19.0	55.0
BV12B	3/4"	3/4"	85.0	13.9	19.0	75.0
BV16B	1"	1"	95.0	17.3	24.0	95.0

NOTES:
 1) ALL DIMENSIONS ARE IN MM. UNLESS SPECIFIED.
 2) PARTS TO BE FREE FROM BURR.
 3) GENERAL TOLERANCE : ± 1MM.
 4) REF. STD. : API 598/608/ISO 17292/ASME B2.1/BS 5351.

TEST PRESSURE		DATE	BY
AIR TEST	7 Kg/Cm ²	01.04.10	AL
HYDRO TEST	BODY	210 Kg/Cm ²	APPROVAL
	SEAT	151 Kg/Cm ²	
NO	DESCRIPTION	SIGN	DATE
REVISION			SCALE : NTS

CUSTOMER :
 TITLE : BALL VALVE, BSP(F), 800#
Swastik Engg. Works
 GOREGAON (EAST), MUMBAI-400 063.
 MATERIAL : DWG. NO : SEW-BV-B REV.:0